

# SHIMANO®

## 1989 REPAIR MANUAL

Shimano American Corporation, One Shimano Dr.  
Irvine, CA 92718

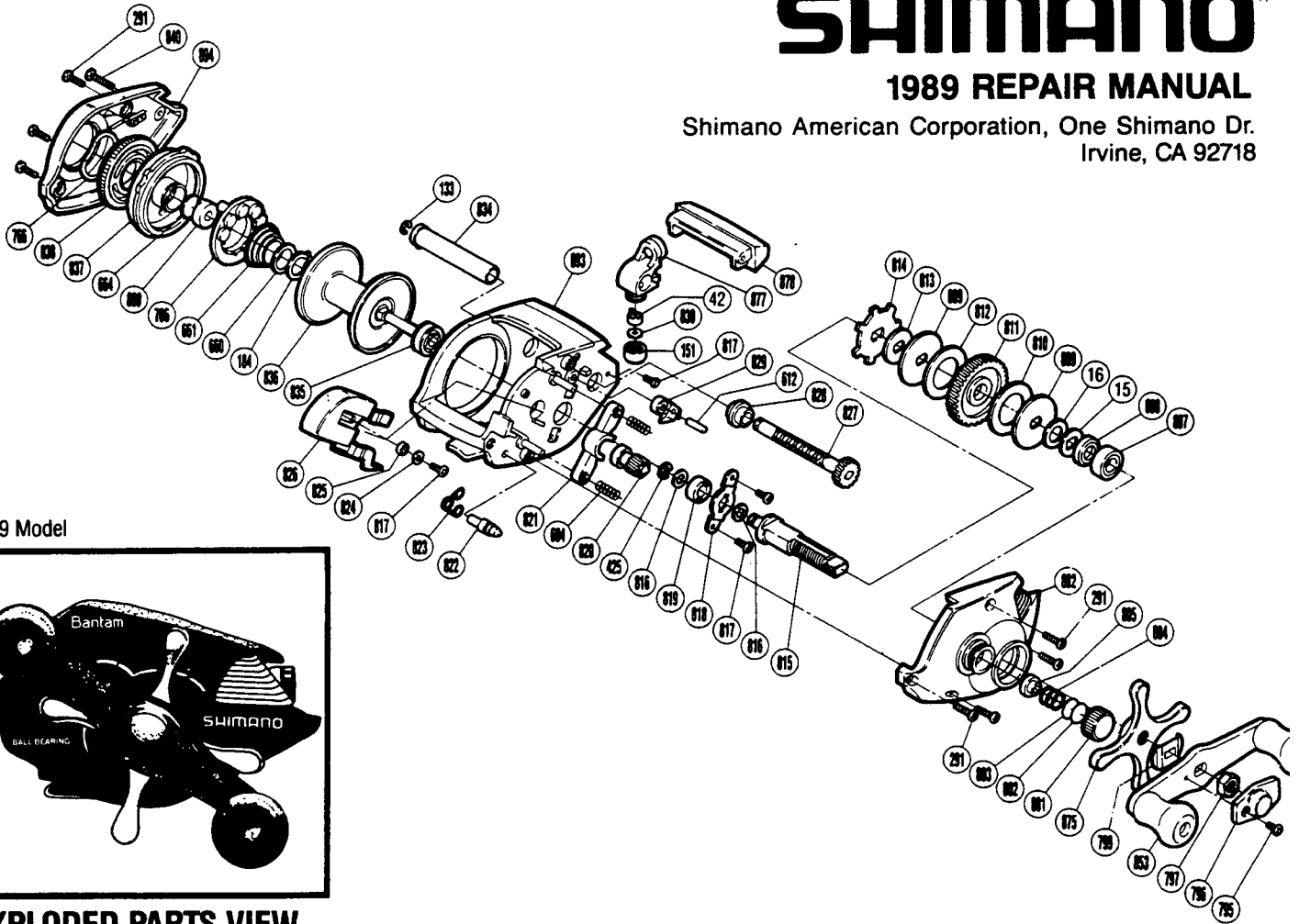

1989 Model

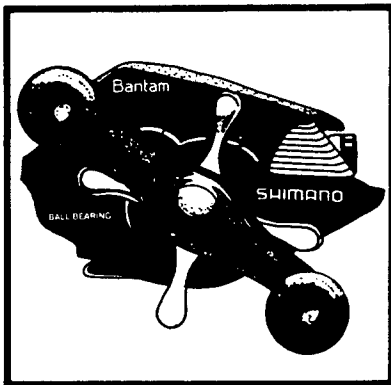

### EXPLODED PARTS VIEW

Bantam  
**P-Mag 1500**

### PARTS LIST

| PART #   | DESCRIPTION              |
|----------|--------------------------|
| BNT 0015 | Drag Spring Washer       |
| BNT 0016 | Friction Washer (C)      |
| BNT 0042 | Line Guide Pawl          |
| BNT 0133 | Worm Shaft Retainer      |
| BNT 0151 | Pawl Cap                 |
| BNT 0184 | Magnet Retainer Lock     |
| BNT 0291 | Side Plate Screw         |
| BNT 0425 | Clutchbutton Lock        |
| BNT 0604 | Yoke Spring              |
| BNT 0612 | Anti-Reverse Pawl Pin    |
| BNT 0660 | Spring Spacer            |
| BNT 0661 | Magnet Retainer Spring   |
| BNT 0664 | Spacer (B)               |
| BNT 0706 | Magnet Retainer          |
| BNT 0766 | Dial Friction Washer     |
| BNT 0795 | Handle Nut Plate Screw   |
| BNT 0796 | Handle Nut Plate         |
| BNT 0797 | Handle Nut               |
| BNT 0799 | Friction Washer          |
| BNT 0801 | Cast Control Cap         |
| BNT 0802 | Spool Tension Spacer (B) |

| PART #   | DESCRIPTION              |
|----------|--------------------------|
| BNT 0803 | Spool Tension Spacer (A) |
| BNT 0804 | Spool Tension Spring     |
| BNT 0805 | Spool Shaft Bushing (A)  |
| BNT 0807 | Drive Shaft Bearing      |
| BNT 0808 | Friction Washer (B)      |
| BNT 0809 | Key Washer (A)           |
| BNT 0810 | Drag Washer (A)          |
| BNT 0811 | Drive Gear               |
| BNT 0812 | Drag Washer (B)          |
| BNT 0813 | Key Washer (B)           |
| BNT 0814 | Anti-Reverse Ratchet     |
| BNT 0815 | Drive Shaft              |
| BNT 0816 | Drive Shaft Washer       |
| BNT 0817 | Multi Purpose Screw      |
| BNT 0818 | Drive Shaft Retainer     |
| BNT 0819 | Drive Shaft Bushing      |
| BNT 0820 | Pinion Gear              |
| BNT 0821 | Yoke                     |
| BNT 0822 | Retractor Spring Pin     |
| BNT 0823 | Retractor Spring         |
| BNT 0824 | Yoke Plate Washer (B)    |

| PART #   | DESCRIPTION             |
|----------|-------------------------|
| BNT 0825 | Yoke Plate Washer (A)   |
| BNT 0826 | Clutch Button           |
| BNT 0827 | Worm Shaft              |
| BNT 0828 | Worm Bearing            |
| BNT 0829 | Anti-Reverse Pawl       |
| BNT 0830 | Spacer (Optional)       |
| BNT 0834 | Level Wind Guard        |
| BNT 0835 | Spool Guard Bushing (B) |
| BNT 0836 | Spool                   |
| BNT 0837 | Dial Case               |
| BNT 0838 | Magnetic Control Dial   |
| BNT 0840 | Left Side Plate Screw   |
| BNT 0853 | Handle Assembly         |
| BNT 0875 | Star Drag               |
| BNT 0877 | Line Guide              |
| BNT 0878 | Level Wind Protector    |
| BNT 0880 | Spool Shaft Bushing (C) |
| BNT 0892 | Right Side Plate        |
| BNT 0893 | One-Piece Frame         |
| BNT 0894 | Left Side Plate         |